

X

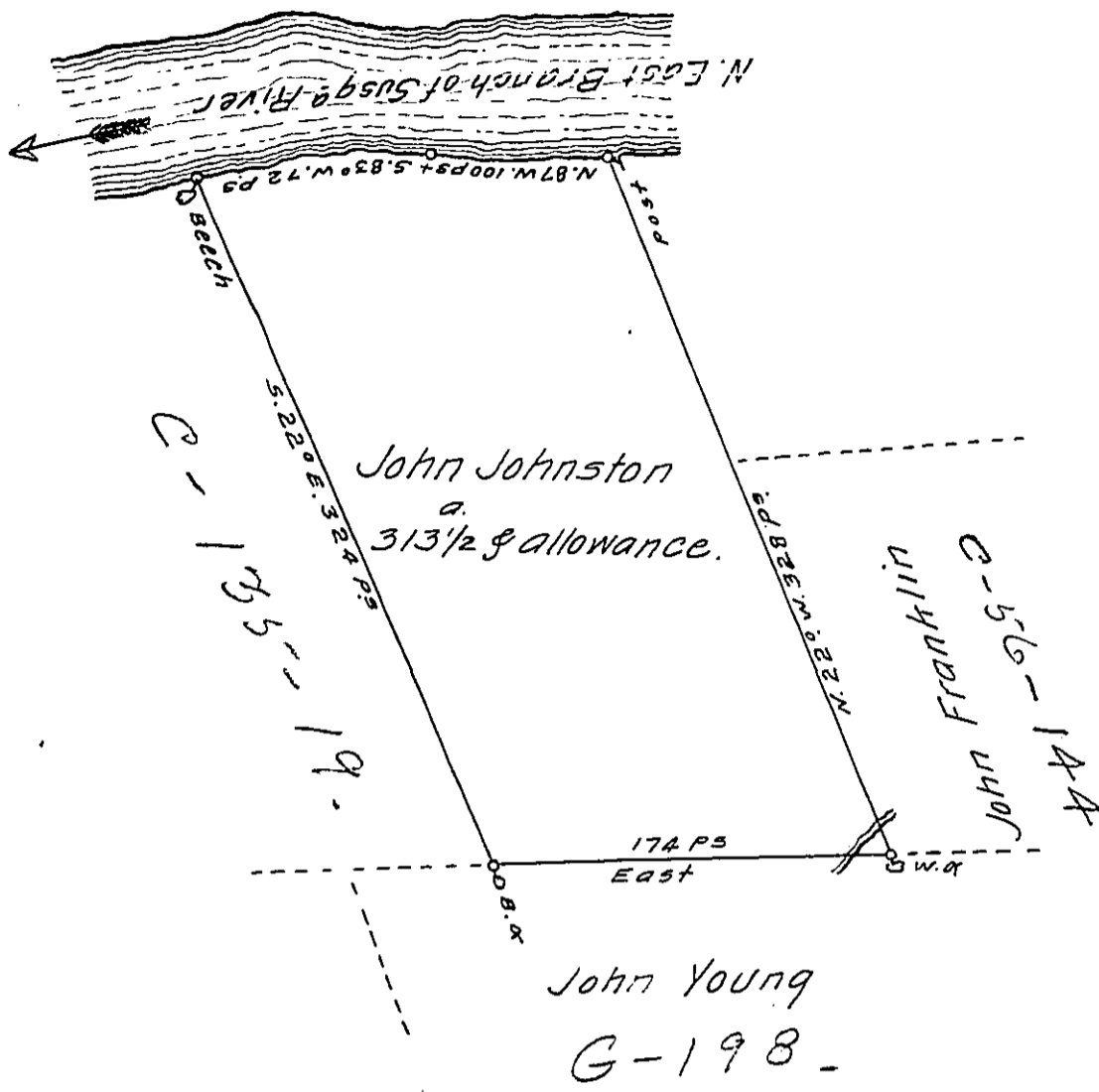

A Draught of a Tract of Land Called— Situate on the East Side of the North East Branch of Susquehanna River adjoining land Claimed by Thomas Gaskin & others in the County of Northumberland. containing three hundred and thirteen Acres & a half Acre besides the allowance of 6<sup>th</sup> Cent for Roads & <sup>to</sup> Surveyed the 12<sup>th</sup> day of April 17<sup>(obl.)</sup> for John Johnston. In Pursuance of a Warrant Dated the 29<sup>th</sup> day of December 1773.

by Chas Stewart, DY. Sur<sup>r</sup>

To John Lukens Esq<sup>r</sup> Survey<sup>r</sup> Gen<sup>l</sup>

IN TESTIMONY that the above is a copy of the original remaining on file in the Department of Internal Affairs of Pennsylvania, made conformably to an Act of Assembly approved the 16th day of February, 1833, I have hereunto set my Hand and caused the Seal of said Department to be affixed at Harrisburg, this sixteenth day of November 1911.

*Henry Howard*  
Secretary of Internal Affairs.